

# SAXDOR 270 GT

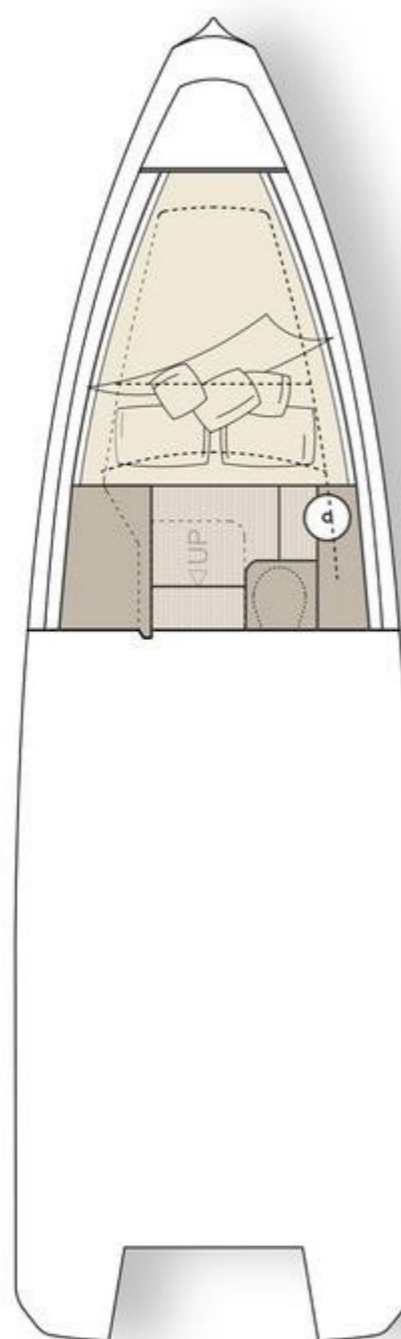

## PRICELIST

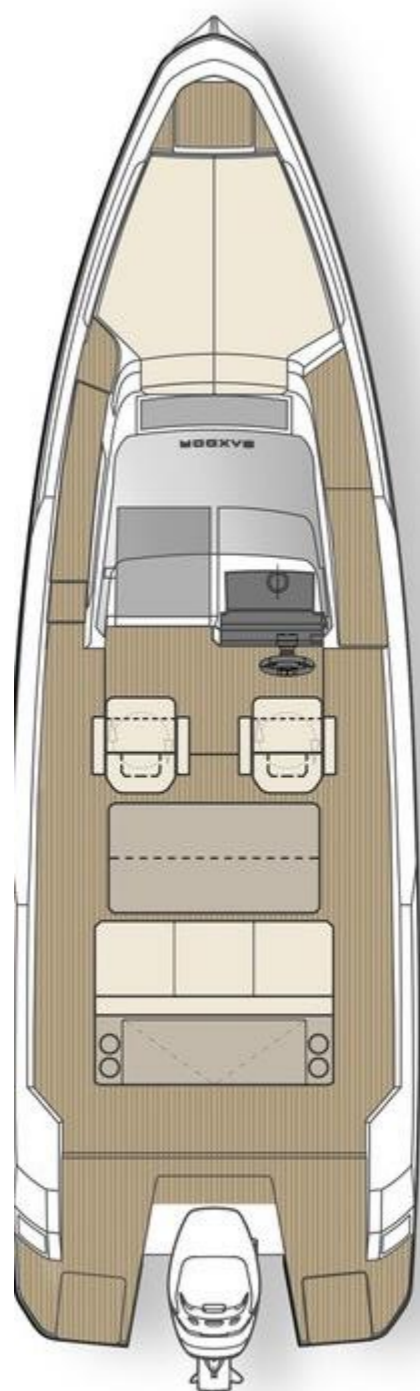

RECOMMENDED RETAIL PRICE INCL. MERCURY V6  
225 CMS

**84 900 € \***

(exl. VAT)

\*Prices valid until 31.8.2023. Recommended customer price exl. VAT and other applicable taxes and costs such as handling, freight and delivery. We reserve the right to modify the specifications of our models without prior notice.

**SAXDOR**  
YACHTS

# TECHNICAL SPECIFICATIONS

\* Specifications may be changed without prior notice. Performance may vary due to equipment, weather and load conditions.

Length	8,45 / 27,72 ft	Fuel tank	300 l
Beam	2,60 m / 8,5 ft	Water tank	80 l
Draft	0,92 m / 3,01 ft	Outboard engines	225 hp -350 hp
Weight (incl. engine)	2600 kg / 5732 lb	Cruising speed	45 knots
Passengers	7	Construction	Vacuum infused GRP
Classification	B Offshore / C Coastal	Hull design	Twin stepped V20* Hull
Berths	2		

## STANDARD EQUIPMENT

### STANDARD FEATURES

Vacuum infused hull
Bow handrails
Anchor storage
Navigation and anchor lights
Lewmar flush hatch in front cabin - 44 cm
Front cabin ventilation
Cupholders in bow area
Side windows
Bow fashion stainless plates
Hull stripes
Electrical wipers for windscreen
Horn
8 cleats
Softpainted console panels
Leather steering wheel
Cupholders on console
Map pocket
Front cabin sliding door with lock
5 separate seats
Harbour cover for console and front seats
Stainless steel bumper list
Bathing ladder
Aft handrails

Fender and mooring storages in aft
Flag pole fitting
3 automatic bilge pumps
1 manual bilge pump
EPA certified fuel lines with tank
Anti skid deck
GRP front storage box with space for optional drawer fridges NEW
Simrad NSX12 single chart plotter with engine data NEW
NMEA2000 network
Mercury VesselView Mobile

### STANDARD EQUIPMENT IN CABIN

Front cabin side windows
Full length 2 persons bed with mattress
Cabin light - 3 pcs
Reading light
Seat cushion
Upholstery panels for cabin walls
Cabin cabinet
Co2 monitor

## ENGINE SELECTIONS

SAXDOR 270 +1 x MERCURY V6 225 CMS	84 900,00 €
SAXDOR 270 + 1 x MERCURY V8 300 AMS (limited availability)	91 900,00 €
SAXDOR 270 + 2 x MERCURY V6 200 CMS (available from July Production) PRICE IS PRELIMINARY	105 900,00 €

## UPHOLSTERY COLORS (only one options can be selected, cannot be combined)

Sahara sand" upholstery (light GRAY with brown stitching)	Standard
"Smoked Orange" upholstery.	810,00 €
"Coffee with cream" upholstery ( dark beige with light stitching)	810,00 €
"Cognac shoot" upholstery (cognac with light stitching)	810,00 €

## GELCOAT HULL COLORS (only one option can be selected, cannot be combined)

White grey	Standard
Deep grey	990,00 €
Beige grey	990,00 €

## OPTION PACKAGES

### ROOF

SkyTop Roof - GRP frame with dark tinted plexi	5 500,00 €
Soft Top - GRP frame with fabric cover	5 500,00 €

### FRESH WATER PACKAGE - ELECTRIC TOILET,

#### SINK AND TAP IN CABIN, SHOWER ON AFT DECK 4 000,00 €

Fresh water tank (80l) with instalation
Sink and tap in front cabin
Electric toilet with fresh water flush (replacing manual toilet)
Black water tank
Shower on aft deck (added to package)

#### WETBAR PACKAGE - including frigde (available only with fresh water package) 4 500,00 €

GRP wetbar module with railings
Glass cover
Sink and tap
Drawer
2 pcs of cup holders
Fridge, Drawer model 50 liters capacity - stainless (added to package)
Sink and tap
Drawer

### SEATING LAYOUT UPGRADE 1 - TWIN SOFA SOLUTION WITH SUNBED

#### (not available with wetbar) 4 800,00 €

2 GRP Boxes with storage and space for drawer fridges (in the forward box)
2 sofas (upholstery)
Cockpit sunbed mattress
Cockpit teak table with cover

#### SAXDOR LIFESTYLE PACKAGE 920,00 €

Saxdor life jackets (4 pcs)
One lifestyle bag with the Saxdor logo

## INDIVIDUAL OPTIONS

### TECHNOLOGY

Bow thruster SE40 with extra battery pre-rigged	3 500,00 €
Catapult windlass with chain	
<u>(can now be selected independently of bow thruster option)</u>	6 500,00 €
Manual trim tabs	990,00 €
Automatic trim tabs	1 790,00 €
Manual trim tabs	975,00 €
Shorepower 230 V	2 745,00 €
Electric stove 230 V	590,00 €

### NAVIGATIONAL TECHNOLOGY

Single MFD Simrad NSX12	<b>STANDARD</b>
2nd Simrad MFD NSX12	3 400,00 €
Halo20+ (only available with Sky Top roof)	3 100,00 €
VHF RS100 including VHF antenna, cabling, mount etc.	1 590,00 €
Echosounder P79 in-hull transducer	299,00 €

### AUDIO OPTIONS

Basic Audio package. 4 x 6,5" Speakers	1 440,00 €
Advanced Audio Package. 8 x 6,5" Speakers. 10" subwoofer and amplifier	4 550,00 €

### COMFORT OPTIONS

Cockpit teak table with cover (included in Seating Layout Upgrade 1 and 2 solution)	2 390,00 €
Drawer fridge 16L in GRP box under helm seat - 12 volt - starboard	980,00 €
Drawer fridge 16L in GRP box under helm seat - 12 volt - port	980,00 €
Glass gates in the aft	1 980,00 €
Webasto 2000 air heater + separate diesel tank	3 790,00 €
Front sunbed cushions including harbour covers	1 440,00 €
Harbour cover for the aft seats (wetbar or sofa)	270,00 €
Sunshade on front deck (av. Only with roof - Sky Top)	750,00 €
Soft deck on deck (gray with black stripes)	3 950,00 €
Drivers Canopy (Only with Hard Top)	1 950,00 €
Water ski pole	1 200,00 €
Deck lights	650,00 €
Mooring kit (6 pcs fenders, 6 pcs mooring ropes, 1 pcs of 7,5 kg stainless steel "Bruce" anchor, 1 pcs of anchor rope)	990,00 €
Windows blinds for the front cabin (Lewmar hatch with mosquito net, side window and skylight)	690,00 €

Total recommended customer price: