

460 GTC

SAXDOR



BIGGER, BOLDER, MORE SAXDOR

The Saxdor 460 GTC combines space, comfort and adaptable living for every moment on board.

A full-beam glass wheelhouse creates a protected yet versatile space, with sliding side doors, opening windows, a retractable sunroof and a sliding aft glass wall. Open everything, and the enclosed grand tourer transforms into a bright, social dayboat.

Two distinct experiences define the 460 GTC. It can be enclosed and climate-controlled for quiet cruising, or fully open for a more connected, outdoor lifestyle. It adapts naturally to changing conditions and different ways of spending time on board.

Underneath, the twin-stepped 20° V-hull delivers a smooth, stable ride with responsive handling, balancing performance with onboard comfort.





DESIGNED TO BE FELT

On board, the 460 GTC is defined by a refined sense of space, where every element is thoughtfully designed.

The wheelhouse brings together soft light, luxurious materials, and clean architectural lines, creating an interior that feels open, balanced, and quietly sophisticated.

Warm tones, tactile surfaces, and panoramic views establish a setting that is both protective and connected to the surroundings.

The main space is shaped for social living, with a natural flow that works just as well underway as it does at anchor.



SAATCHI

ONE SPACE, TWO EXPERIENCES

The 460 GTC adapts to how you want to spend time on board.

With everything closed, the wheelhouse becomes a calm, protected environment. It is quiet, comfortable, and well suited for longer journeys in any conditions.

Open it up, and the character changes completely. Glass slides away, boundaries disappear, and the deck connects seamlessly to the surroundings.

The same space moves effortlessly from focused cruising to a more social, open-air setting, giving you the freedom to choose how you use it at any moment.





OPEN TO THE WATER

Generous fold-down terraces span nearly a third of the boat's length, opening up a wider, more spacious living area.

Together with the wheelhouse, the layout flows from edge to edge, creating a seamless connection between inside and out.

This creates a closer connection to the water and a space designed for entertaining, relaxing, and enjoying time on board.





PERFORMANCE MEETS COMFORT

The 460 GTC combines the agility of a sport boat with the comfort and space designed for extended time on board.

On the water, it feels responsive and engaging to drive, with a smooth and controlled ride even at higher speeds.

At the same time, life on board remains quiet and composed, offering the comfort needed for longer stays.

This balance defines the character of the 460 GTC. It is equally suited for dynamic driving and relaxed time on board.





SAXDOR

MERCURY

500 HP

500 HP

500 HP

500 HP

500 HP

500 HP

500 HP

500 HP

500 HP

500 HP

500 HP

500 HP

500 HP

500 HP

SPACE TO SETTLE IN

Below deck, the 460 GTC follows the same refined design approach.

A spacious forward cabin is complemented by a twin mid cabin beneath the wheelhouse, creating a layout that is practical and well balanced.

The interior is finished in a light palette, with soft lighting, warm wood veneers, and clean, linear cabinetry that define a calm, cohesive atmosphere.

A bathroom with a separate shower completes the layout, making it well suited for overnight stays and extended weekends on board.





LAYOUTS & SPECS

SPECIFICATIONS

Length	14.4 m / 47.2 ft
Beam	4.1 m / 13.45 ft
Draft (excl. engines)	0.8 m / 2.62 ft
Berths	4+2
Max. engine power	1275 hp
Max. speed range	40–50 knots
Fuel tank	1330 L / 351 gal
Fresh water	160 L / 42 gal
Outboard engines	900 hp – 1275 hp
Construction	Vacuum infused GRP
Hull design	Twin-stepped v20° Hull

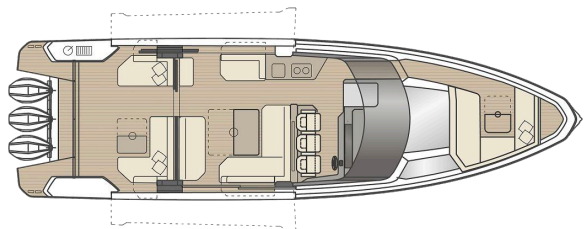

01 Main deck

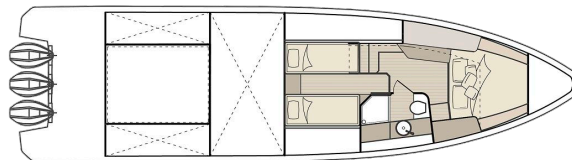

02 Lower deck

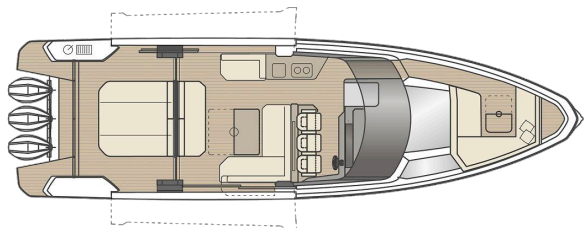

03 Main deck with aft cabin

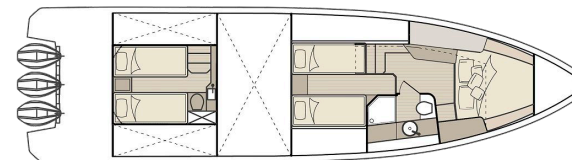

04 Lower deck with aft cabin

THE FUTURE TAKES SHAPE

Saxdor was founded in 2019 by Sakari Mattila, bringing decades of experience from Finland's leading boat brands. From the start, the brand introduced a bold new approach to boating, combining agile performance with thoughtful, well-designed usability on board.

Since then, the range has evolved rapidly, from the early models to the latest 460 series, introducing new levels of space, versatility, and onboard living.

Today, Saxdor offers a complete range of boats built on the same core principles: lightweight Scandinavian construction, sharp hydrodynamics, and thoughtfully designed deck space.

From the sporty 270 GTO to the flagship 460 GTC, every model delivers a confident, efficient, and rewarding experience on the water.

THE ENTIRE SAXDOR RANGE

270 GTO

320 GTO

320 GTC

340 GTWA

400 GTC

400 GTO

400 GTS

460 GTC



GLOBAL NETWORK

Saxdor is present wherever boating matters most — through a network of over 180 dealer locations across more than 70 countries and territories on 5 continents.

Wherever you are, our global network brings you closer to the brand, with local expertise and seamless access to our boats and services.

Together with our dealer partners, we participate in more than 100 boat shows and water sports exhibitions every year — from Cannes and Düsseldorf to Miami and Singapore. Each event is an opportunity to explore the Saxdor range on the water, discover the full lineup through our digital showroom, meet the team, and join the growing community of owners worldwide.



FIND US AT A SHOW NEAR YOU

Scan to see our upcoming exhibitions
and book a private sea trial.

saxdor.com/events

